

# SP55\*W SP56\*W

Natural frequency : (1)  
15 to 20 Hz



## DESCRIPTION

Machine mount available with a stud (SP55\*W) or threaded hole (SP56\*W).

- Top cup and stud are mild steel zinc plated.
- Stainless steel wire mesh cushion.
- Natural frequency between 15 to 20 Hz.

## APPLICATIONS

- Mount for low loads.
- Suitable for rotating machines (> 2500 rpm) and laboratory equipment ...

## OPERATING CHARACTERISTICS

| Reference with thread. stud | Reference with tapped hole | Ø D1 (mm) | Ø D2 (mm) | H (mm) | h* (mm) | G  | Static load (daN) | Deflection under load (mm) |
|-----------------------------|----------------------------|-----------|-----------|--------|---------|----|-------------------|----------------------------|
| SP550W                      | SP560W                     | 28        | 23,6      | 17,5   | 20      | M6 | 60                | 4,2                        |
| SP551W                      | SP561W                     | 40        | 34,5      | 17     | 20      | M6 | 100               | 4,8                        |
| SP552W                      | SP562W                     | 45        | 40        | 22     | 25      | M8 | 150               | 5,6                        |
| SP553W                      | SP563W                     | 58        | 53,6      | 22     | 25      | M8 | 225               | 6,3                        |

\* SP55\*W only

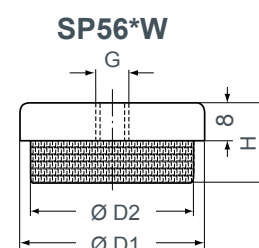
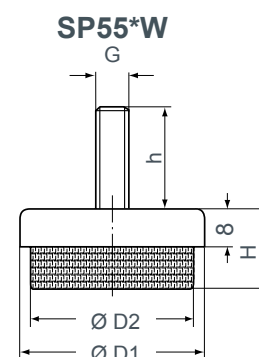

(1) Natural frequencies with max/min loads, see : OPERATING CHARACTERISTICS.